

Latimea danturii "h" per modul: 17 mm

Latimea totala "H" per modul: 30 mm

Unghi de angrenare: 20°

Material: otel C45E-UNI EN 10083-1

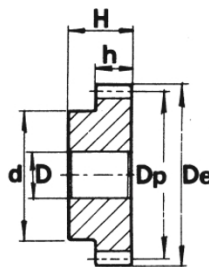
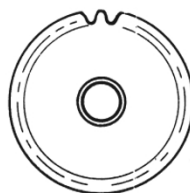

Z (numar de dinti)	Cod	De (mm)	Dp (mm)	d (mm)	D (mm)
12	PM 27012	21,0	18,0	14	8
13	PM 27013	22,5	19,5	14	8
14	PM 27014	24,0	21,0	17	8
15	PM 27015	25,5	22,5	18	8
16	PM 27016	27,0	24,0	20	8
17	PM 27017	28,5	25,5	20	8
18	PM 27018	30,0	27,0	20	8
19	PM 27019	31,5	28,5	20	8
20	PM 27020	33,0	30,0	25	8
21	PM 27021	34,5	31,5	25	10
22	PM 27022	36,0	33,0	25	10
23	PM 27023	37,5	34,5	25	10
24	PM 27024	39,0	36,0	25	10
25	PM 27025	40,5	37,5	25	10
26	PM 27026	42,0	39,0	30	12
27	PM 27027	43,5	40,5	30	12
28	PM 27028	45,0	42,0	30	12
29	PM 27029	46,5	43,5	30	12
30	PM 27030	48,0	45,0	30	12
31	PM 27031	49,5	46,5	35	12
32	PM 27032	51,0	48,0	35	12
33	PM 27033	52,5	49,5	35	12
34	PM 27034	54,0	51,0	35	12
35	PM 27035	55,5	52,5	35	12
36	PM 27036	57,0	54,0	35	12
37	PM 27037	58,5	55,5	40	12
38	PM 27038	60,0	57,0	40	12
39	PM 27039	61,5	58,5	40	12
40	PM 27040	63,0	60,0	40	12
41	PM 27041	64,5	61,5	50	14
42	PM 27042	66,0	63,0	50	14
43	PM 27043	67,5	64,5	50	14
44	PM 27044	69,0	66,0	50	14
45	PM 27045	70,5	67,5	50	14
46	PM 27046	72,0	69,0	50	14

Z (numar de dinti)	Cod	De (mm)	Dp (mm)	d (mm)	D (mm)
47	PM 27047	73,5	70,5	50	14
48	PM 27048	75,0	72,0	50	14
49	PM 27049	76,5	73,5	50	14
50	PM 27050	78,0	75,0	50	14
51	PM 27051	79,5	76,5	60	15
52	PM 27052	81,0	78,0	60	15
53	PM 27053	82,5	79,5	60	15
54	PM 27054	84,0	81,0	60	15
55	PM 27055	85,5	82,5	60	15
56	PM 27056	87,0	84,0	60	15
57	PM 27057	88,5	85,5	60	15
58	PM 27058	90,0	87,0	60	15
59	PM 27059	91,5	88,5	60	15
60	PM 27060	93,0	90,0	60	15
61	PM 27061	94,5	91,5	70	20
62	PM 27062	96,0	93,0	70	20
63	PM 27063	97,5	94,5	70	20
64	PM 27064	99,0	96,0	70	20
65	PM 27065	100,5	97,5	70	20
66	PM 27066	102,0	99,0	70	20
67	PM 27067	103,5	100,5	70	20
68	PM 27068	105,0	102,0	70	20
69	PM 27069	106,5	103,5	70	20
70	PM 27070	108,0	105,0	70	20
120	PM 27120	183,0	180,0	70	20